

## Cornerstone Preparatory Academy Middle/High School Block Additions

In 2016, our 5-year Strategic Plan called for the eventual construction of middle and high school blocks in order to allow our older students to continue to receive the best education possible in Kenya. We took steps then to have an architect draw up a master plan layout creating a space for these facilities (see buildings in red). NB (upper primary = middle; secondary = high school)

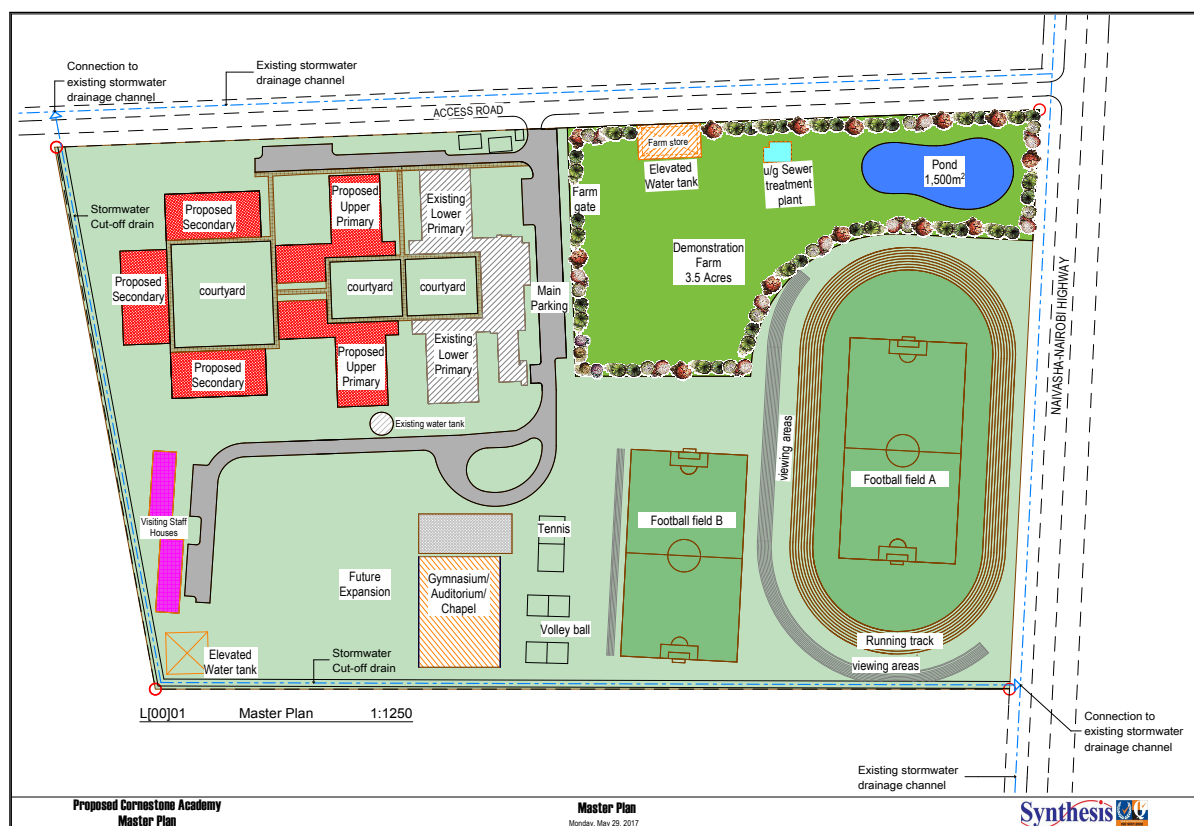

We now have 220 K-8 students using 10 classrooms, and have no facilities to educate our high school students, no free rooms for rising students from LEAP Preschool in Jan '20, and not enough space to allow specialized teaching of middle school students. We must act now to expand our infrastructure.

\*Ron Hamilton has graciously done the design drawings for the planned facilities pro bono (see following pages)

\*Price Modern, LLC in Baltimore, MD is donating \$100K in new school furnishings + shipping costs to Kenya.

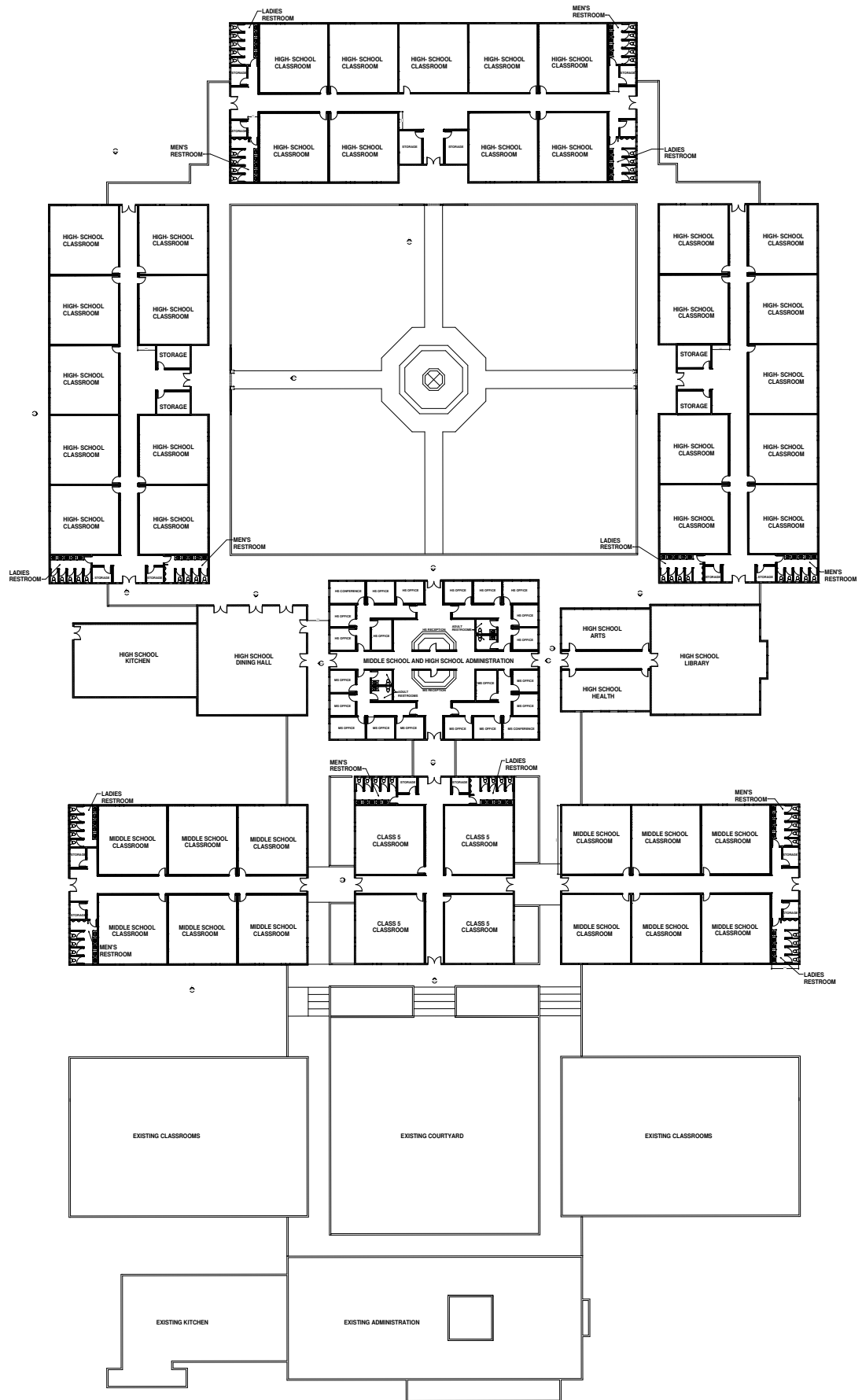



Total Square Feet of New Construction: 76,109 sq. ft.

Cost Per Sq. Ft. for Construction of prior buildings: \$38

Total Est. Cost for Construction of Middle and High School  $76,109 \times \$46 =$  **\$2,892,142**

We plan to initiate construction once we have all architectural and engineering drawings, approval of drawings, environmental impact assessment, and 75% of funds raised. Ideally, this would be by early 2020, since construction is expected to take 18-24 mos.

### **How You Can Help:**

Please contribute to help make this next phase of our vision a reality in one of the following ways:

- Online by credit card or EFT – go here  
<https://naomisvillage.kindful.com/?campaign=1016978>
- By mailing your contribution to: Naomi's Village, Inc.  
PO Box 270057  
Flower Mound, TX 75027-0057
- By donating stock - please contact Kim Ramsey at (972) 979-4836

**Click on this link to watch a 90-second video!** <https://vimeo.com/333413594/a6aeca62a>