

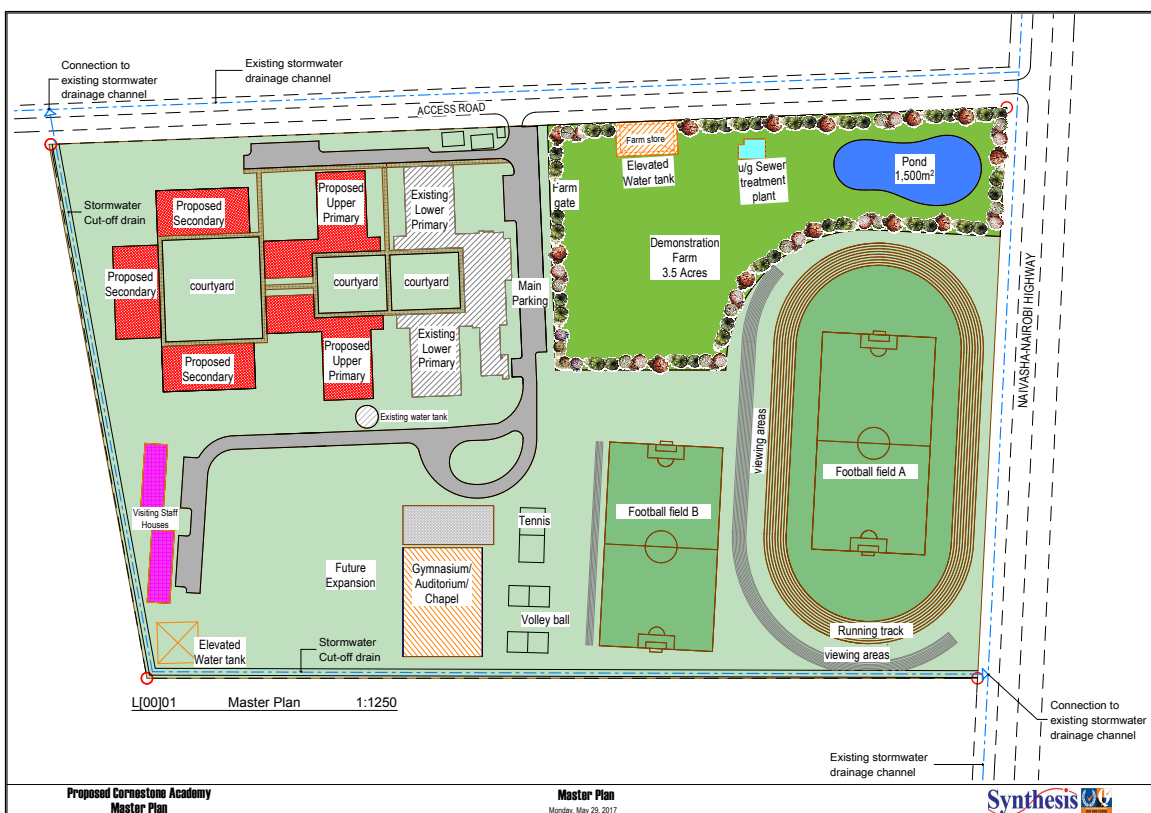

Cornerstone Middle/High School Construction

In 2016, our 5-year Strategic Plan called for the eventual construction of middle and high school blocks so our older students could continue to receive the best education possible in Kenya. We had an architect design a master plan including space for these facilities (see buildings in **red** below). N.B. (upper primary = middle; secondary = high school). When completed, our capacity will increase to 900 students total.



Design plans on the next page include 43 new classrooms, an admin block, dining hall, kitchen, library, arts building, and health center. These were done pro-bono by US Board of Trustees member Ron Hamilton.

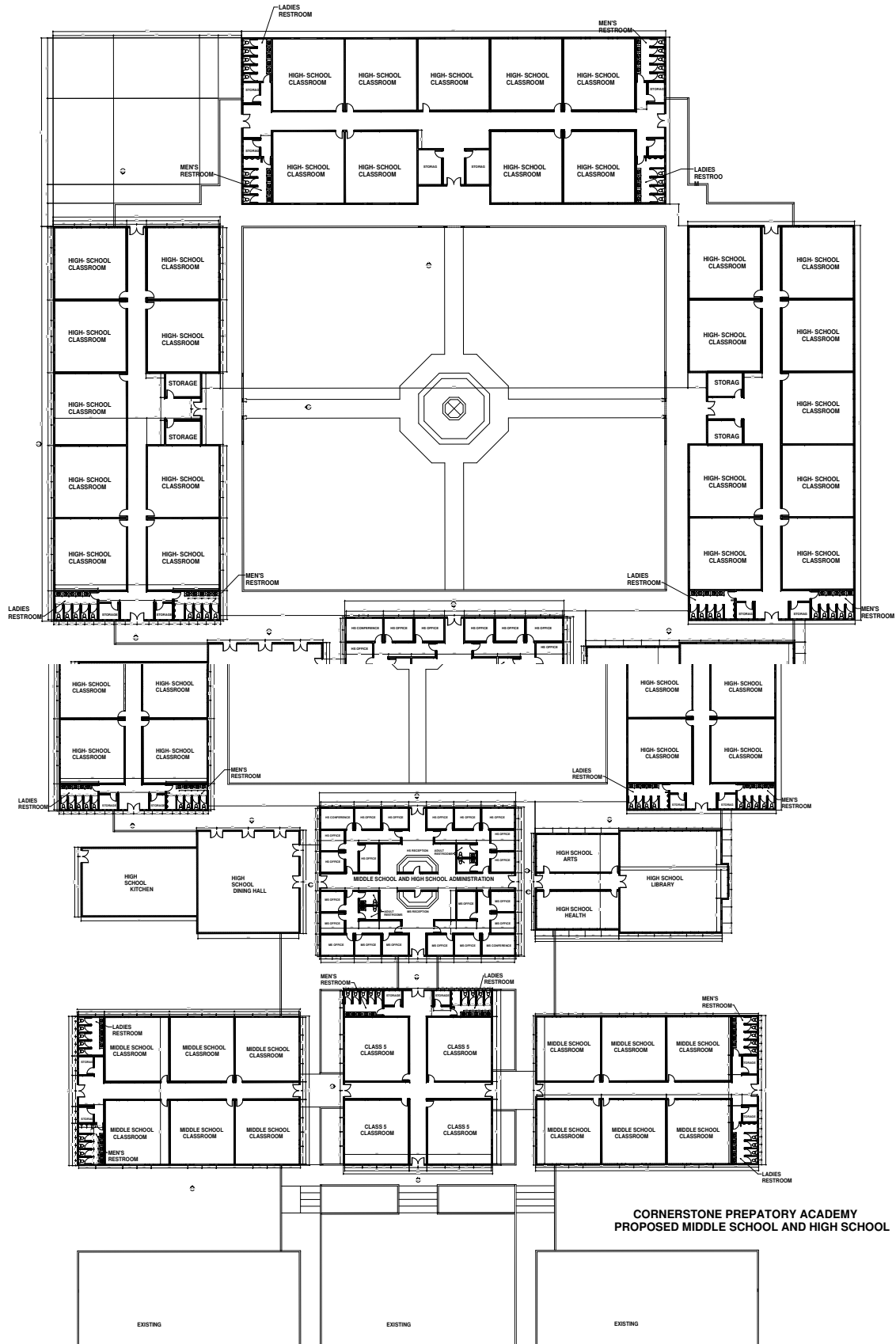

CORNERSTONE PREPATORY ACADEMY
PROPOSED MIDDLE SCHOOL AND HIGH SCHOOL

Our Project by the Numbers...

Funds raised as of Oct. 20, 2020, after admin percentage of 13% removed = ~ \$500,000

Kitchen and dining hall for middle school (MS) and high school (HS) were already funded by The Lennox Foundation via a grant of \$96,000 in April 2019.

Total estimated cost of construction is 76,000 sq. ft x \$35/ sq. ft. = \$2.66M

Remaining amount to raise = \$2.16M

Estimated start of construction - Nov 2020

Length of construction - 24 months

Give to help us reach these goals:

A. 100 sq. ft. of finished middle or high school construction @ \$35/sq. ft. = \$3,500

B. (43) HS or MS Classrooms = 1,000 sq. ft. x \$35/sq. ft. = \$35,000 each

2 -HS or MS Classrooms with hallway between = 2,296 sq. ft. x \$35/sq. ft. = \$80,360

2-HS or MS classroom block with boys' and girl' bathrooms, 2 storerooms, and hallway = 3,177 sq. ft. x \$35/sq. ft. = \$112,000

4 -HS or MS classroom block with boys' and girls' bathrooms, 2 storerooms, and hallways = 5,460 sq. ft. x \$35/sq. ft. = \$191,000

6 -MS classroom block with boys' and girls' bathrooms, 2 storerooms, and hallways = 7,943 sq. ft. x \$35/sq. ft. = \$278,000

C. MS/HS Library = 2,484 sq. ft. x \$35/ sq. ft. = \$86,940

D. MS/HS Health Center = 963 sq. ft. x \$35/ sq. ft. = \$33,705

E. MS/HS Arts Center = 963 sq. ft. x \$35/ sq. ft. = \$33,705

F. (10) Admin offices = 137 sq. ft. x \$35/ sq. ft. = \$4,795 each

G. (2) Admin office blocks (5 offices, men's and women's bathrooms, hallways) = 1,125 sq. ft. x \$35/ sq. ft. = \$39,375

- H. (2) MS or HS Conference Rooms = 167 sq. ft. x \$35/ sq. ft. = \$5,845 each
- I. (2) MS or HS Reception Areas = 156 sq. ft. x \$35/ sq. ft. = \$5,460 each
- J. Outdoor covered passageways (with lighting, rough stone floor, columns, roofs) = 9,200 sq. ft. x \$18/ sq. ft. = \$165,600
- K. Water tower with 20,000L tank, meter, plumbing, and pump = \$30,000 estimated
- L. Architectural/ engineering plans and construction supervision = 7% x 2.66M = \$186,200

Thank you and God bless you for your generosity in helping us to see our total enrollment at Cornerstone grow to 900 students over the next 5 years as we build in this additional capacity!

Dr. Bob and Julie Mendonsa
Naomi's Village | Hope Begins When a Child Belongs
(972) 979 - 4836 | (214) 763 - 8311

To Contribute:

Give by check (no fees):

Naomi's Village, Inc.
P.O. Box 270057
Flower Mound, TX 75027-0057



Give via NV Website:

naomisvillage.org/currentneeds

Give Stock Gifts (no fees):

Agent:

Vanguard
455 Devon Park Drive Wayne, PA 19087-1815
800.345.1344

DTC#: 0062

Account#: 17690887

Account Name: Naomi's Village

